

RacloFlex metal

TECHNICAL DATA SHEET



Position	Secondary cleaner
1 or 2 ways working	1 way
Maximum speed	3m/s
Blade type	Curved mono segmented blade
Tension	Side rubber silent blocs
Wear compensation	Manual blade adjustment
Pressure	Pushing screw
Blade fixing	bolted
Mechanical splicing	Not recommended (tungsten carbide)
Tungsten carbide abrasion resistant quality	93 HRA
Tungsten carbide impact resistant quality	66 HRA
Tungsten size	th.3xh.10
Structure quality	Steel ST37 (optional stainless steel)
Shaft size	Ø42,4 th.4
Bolts quality	Stainless steel
Ambient temperature range	-10°C / +50°C
Product temperature range	0°C / +120°C

03/2023

RacloFlex metal

Spare parts
SPRF 171127 191 - EN

Pressure by pulling (with optional 723)

Pressure by pushing (without 723)

Optional

Optional

Example

Dimensions in millimeter

N°	Designation	Laterality	Quality	Variant(s)	Belt	Blade 153 Qty	Scraping width	Other Parts
117	Double Nut NT		Galva. ST	127: Stainless Steel				
153	Blade T - Tungsten 3mm		Tng3 + Galva. ST	154:Tng.Impact / 161: SST only / 160:Alumina / 163:Tng3+SST				
317	Structure Sw.metal		Galva. ST	337: SST	500	4	504	721;722;544 ;525
451	Multitool wrench (optional)		Galva. ST		650	5	630	721;722;544 ;525
452	Cap		PVC					
455	Shift ring (optional)		Galva. ST	475: SST				
525	Bearing QL - Medium		Galva. ST	535: SST	800	6	756	721;722;545;525
544	Silent Bloc Small BW400-650	L or R	Paint. ST + NR	554: SST + NR	1001	7	882	721;722;545;525
545	Silent Bloc Medium BW800-1400	L or R	Paint. ST + NR	555: SST + NR	1002	8	1008	721;722;545;525
721	Angle Medium only		Galva. ST	731: SST	1200	9	1134	721;722;545;525
722	Angle Bridge Medium		Galva. ST	732: SST				
723	Pulling Tab Medium (optional)		Galva. ST	733: SST	1401	10	1260	721;722;545;525
737	Pressure Bolt Medium -Long M16x190		SST		1402	11	1386	721;722;545;525

RacloFlex metal



Conveyor Solutions Expert

INSTRUCTIONS

Attention - Warning - Warnung

Jamais d'impact sur le carbure de tungstène / No impact on tungsten carbide / keine Auswirkung auf Hartmetall

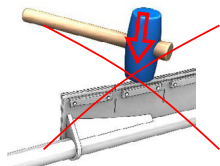

Incompatible bande reversible / Not compatible reversible belt / Nicht kompatibel mit Reversierbänder

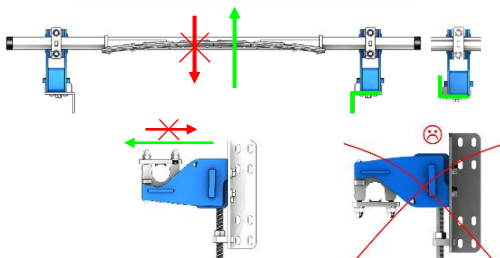

Mise en pression / Pressurization / Druck Einstellung

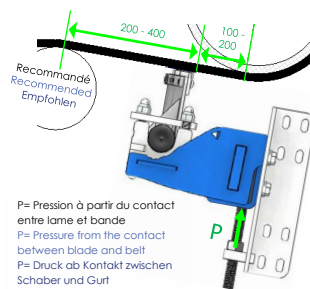

P = Pression à partir du contact entre lame et bande
 P = Pressure from the contact between blade and belt
 P = Druck ab Kontakt zwischen Schaber und Gurt

BT BW BB	P (mm)
500	6
650	7
800	9
1000	11
1200	13
1400	15
1600	17
1800	19
2000	22

Axes et réglage de la largeur / Axes and width adjustment / Achsen und Breitereinstellung

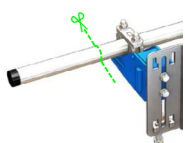

Désengager / Desengage / Ausrücken

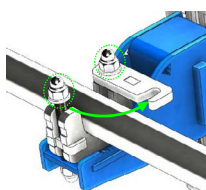

Remplacement / Replacing / Ersatz

Arrondir les coins extérieurs / Round the outside corners / Runde die äußere ecke



Régler suivant usure ou forme / Adjustment according to wear or shape / Folgender Verschleiß oder Einstellung Form

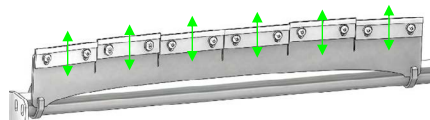

Dimensions

