

RacloFlex WP

Spare parts
SPRF 171010 101 - EN

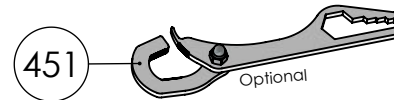
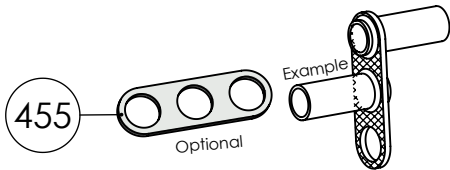
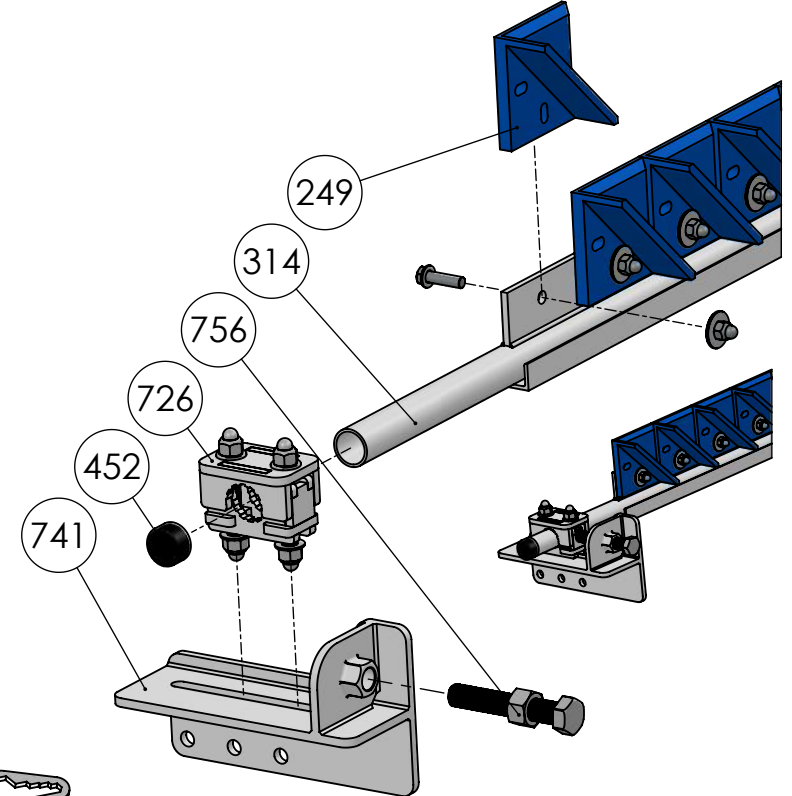
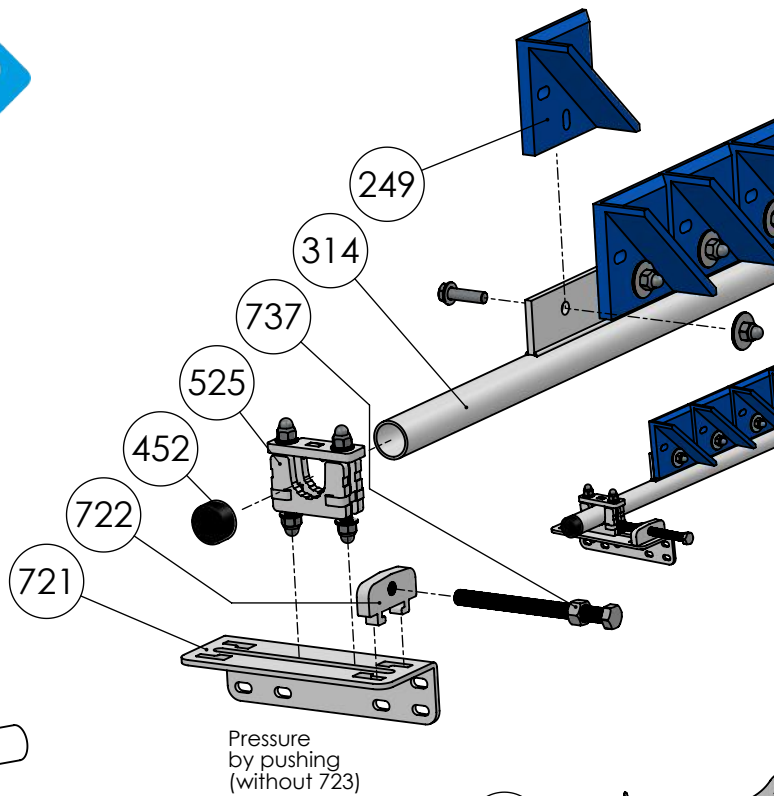
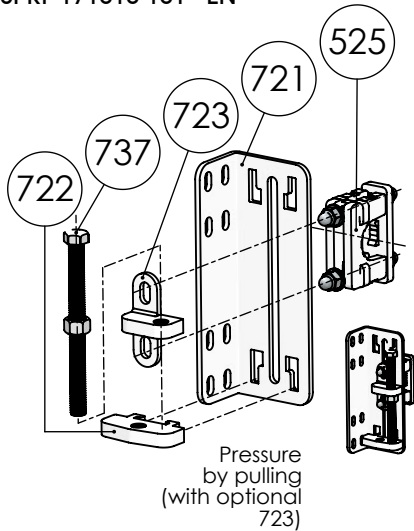
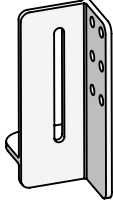
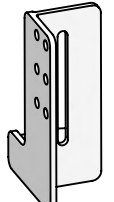

Dimensions in millimeter

N°	Designation	Laterality	Quality	Variant(s)	Size	Blade 249 Qty	Tube 314 length	Support size	Left		Right	
									Left	Right		
249	Blade WP		PUR									
314	Support tube		Galva. ST	334: SST	378	3	500	721+525	 			
					504	4	650	721+525				
					630	5	800	721+525				
451	Multitool Wrench (Optional)		Galva. ST		756	6	1000	721+525				
452	Cap		PVC		882	7	1200	721+525				
					1008	8	1200	721+525				
455	Shift ring (Optional)				1134	9	1400	721+525				
					1260	10	1600	721+525				
525	Bearing QL - Medium		Galva. ST	535: SST	1386	11	1600	721+525				
					1512	12	1600	721+525				
526	Bearing QL - Large		Galva. ST	536: SST	1638	13	1800	741+526				
					1764	14	2000	741+526				
721	Angle medium alone		Galva. ST	731: SST	1890	15	2000	741+526				
					2016	16	2200	741+526				
					2142	17	2200	741+526				
722	Angle bridge medium		Galva. ST	732: SST								
723	Pulling tab medium (Optional)		Galva. ST	733: SST								
737	Pressure Bolt Medium -Long M16x190		SST									
741	Angle large	L or R	Galva. ST	751: SST								
756	Pressure Bolt Large M24x140		SST									